

High-Capacity Ink Pack Adapter (UV)

VJ-HCIPADPT-UV6

Operation Manual

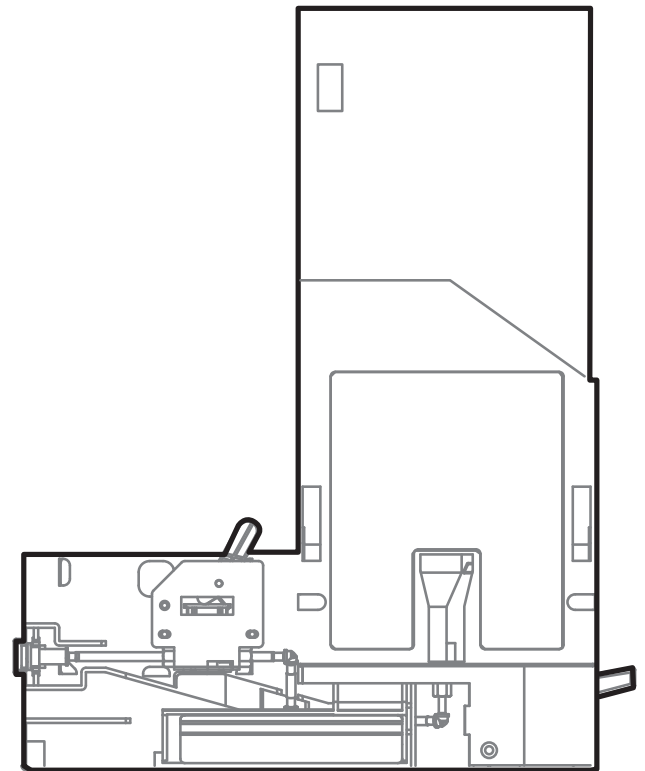

Read This Manual Before Using The Product

Table of Contents

1	Introduction	3
1.1	Purpose of This Manual and Its Target Readers	3
1.2	Safety Instruction	3
1.3	Warning labels	4
1.3.1	Precautions on handling the warning labels	4
1.3.2	Warning label locations and types	5
2	Checking the Contents	6
2.1	Contents in the Box	6
2.2	Assembling the Light-shielding Cases	7
3	How to Use	9
3.1	Installing Ink Packs	9
3.2	When High-Capacity Ink Pack Adapter is removed from Printer	15
3.3	Replacing Connector Rubber	18

<MEMO>

1 Introduction

1.1 Purpose of This Manual and Its Target Readers

This manual describes how to use High-capacity ink pack adapter of MUTOH INDUSTRIES LTD.

This manual is prepared for the users of this product.

Before using this product, make sure to fully understand the contents and directions in this manual.

CAUTION

- **No part of this product or publication may be reproduced, copied, or transmitted in any form or by any means, except for personal use, without the permission of MUTOH INDUSTRIES LTD.**
- **The product and the contents of this publication may be changed without prior notification.**
- **MUTOH INDUSTRIES LTD. has made the best efforts to keep this publication free from error, but if you find any uncertainties or misprints, please call us or the shop where you bought this product.**
- **MUTOH INDUSTRIES LTD. shall not be liable for any damages or troubles resulting from the use of this equipment or this manual.**

1.2 Safety Instruction

The contents of warnings are categorized into the following 2 types depending on the degree of risk (or the scale of the accident).

Make sure to understand the meaning of the following warning terms, and follow the instruction in this manual.

Safety terms	Details
 CAUTION	Must be observed to avoid slight or moderate bodily injury or damage to the whole or each part of the product.
NOTE	Used for the information that needs special attention or emphasis.

1.3 Warning labels

This section explains the handling of the warning labels, locations where they are placed, and their different types.

Warning labels are applied to the product in places where special attention is required.

Please ensure that you understand the exact locations of such parts and the contents of the danger before operating this product.

1.3.1 Precautions on handling the warning labels

Please pay attention to the points listed below when handling the warning labels.



NOTE

- Make sure you can read all the contents on a warning label.
If some of words or diagrams cannot be read, please clean the label.
 - To remove dirt from the warning labels, please use a cloth, water, and mild detergent.
Do not use organic solvents or gasoline to clean the labels.
 - It is necessary to replace the labels if they are damaged, lost or illegible.
If the warning labels have to be replaced, contact to your local MUTOH dealer.
-

1.3.2 Warning label locations and types

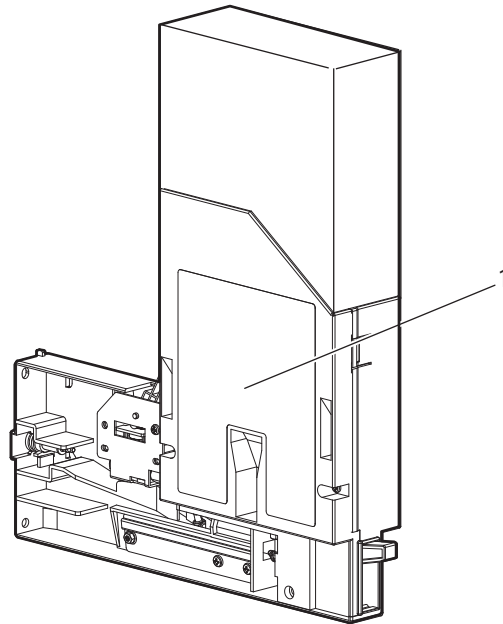
The diagram below indicates the locations of the warning labels.

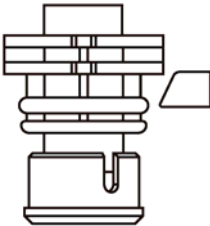

No.	Types of warning label
1	<div style="text-align: center; background-color: yellow; border: 1px solid black; padding: 5px;">  CAUTION 注意 </div> <ul style="list-style-type: none"> ◆本製品取付け時の機体状態 VJ16、19、26シリーズはカートリッジ横挿し状態にしてから本製品をセットしてください。縦挿し状態でセットすると以下の症状が発生する場合があります。 ※インク残量を正しく検知しない場合があります。 ※インク漏れが発生する場合があります。 ◆インクパックを奥まで押し込み、ロックしている事を確認してください。 ※正しくロックされていないとインク漏れが発生します。 ◆インク充填済のプリンタで初めて使用する際は、初期充填を実施してください。 初期充填をしない場合、気泡によるノズル抜けを起こす場合があります。 ◆パックのみの脱着 本体の電源が入っている状態で本製品から、インクパックを抜かないでください。 ※そのスマートチップは使用不可となります。 ◆アダプタープラグ交換 パネルの警告に従いアダプタープラグを交換して下さい。 ※パネル警告後、同じアダプタープラグを使い続けるとインク漏れが発生する場合があります。 ◆ Conditions for Product use: Contact dealer for printer compatibility - be sure cartridge holder is in the horizontal position. Inserting the ink pack and adapter with the cartridge holder in a vertical position will result in the following cases, ※Remaining ink volume discrepancies. ※Ink leakage ◆ When inserting new ink packs: Confirm ink pack is fully seated by checking the lock mechanism is at the top of the ink delivery neck through the observation window, see proper placement in image below. Be sure to perform an initial ink charge to remove air bubbles that can form in tubing of the adapter. ◆ Do NOT insert/remove Ink Bag Only from printer: When replacing ink packs, always power down printer, then remove entire adapter assembly from the printer. Caution - Smart Card will become corrupted if ink pack is removed from the adapter with power on. ◆ Adapter Plug: According to the panel warning, replace the adapter plug. ※If the same adapter plug is used continuously after the panel warning is displayed, ink leakage may occur. <div style="display: flex; justify-content: space-around; margin-top: 20px;"> <div style="text-align: center;">  <p style="font-size: 24px; font-weight: bold; margin-top: 10px;">NG</p> </div> <div style="text-align: center;">  <p style="font-size: 24px; font-weight: bold; margin-top: 10px;">OK</p> </div> </div>

2 Checking the Contents

After unpacking the container box, check that the printer is not damaged and that all necessary parts are there.

NOTE

- After checking, if the printer is damaged or there is something missing, contact your local MUTOH dealer.

2.1 Contents in the Box

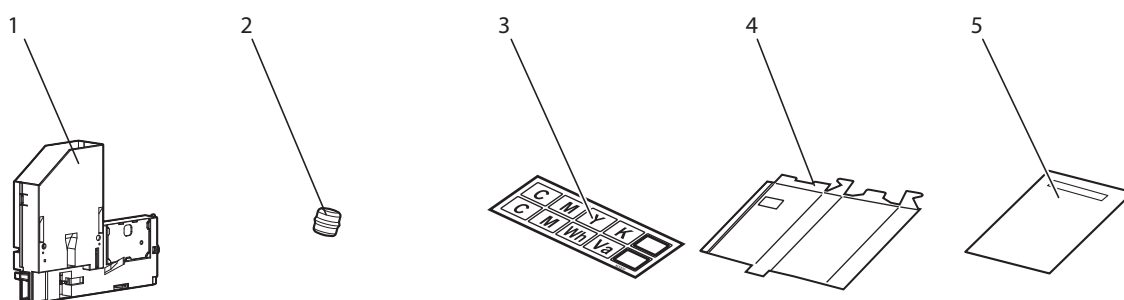

No.	Part Name	Quantity	No.	Part Name	Quantity
1	High-capacity ink pack adapter	6	4	Light-shielding case	6
2	Connector rubbers	20	5	Operation Manual (this manual)	1
3	Ink Color Label	1			

2.2 Assembling the Light-shielding Cases

1. Check the outer and the inner sides of the light-shielding case.

- The rough surface with double-sided tape on it is the outer side of the light-shielding case.

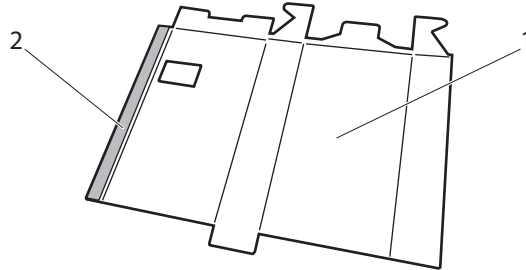

No.	Part Name
1	Light-shielding case (Outer side)
2	Double-sided tape

2. Fold along the creases in the light-shielding case.

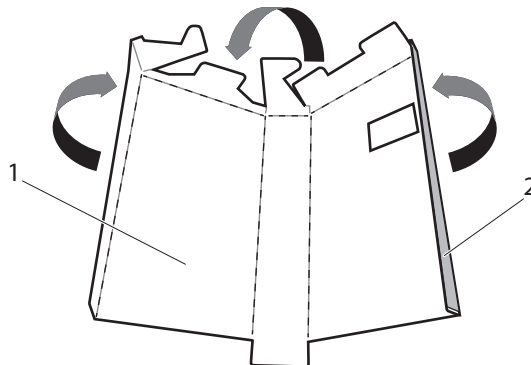

No.	Part Name
1	Light-shielding case (Inner side)
2	Double-sided tape

3. Peel off the cover on the double-sided tape, and connect the light-shielding case.

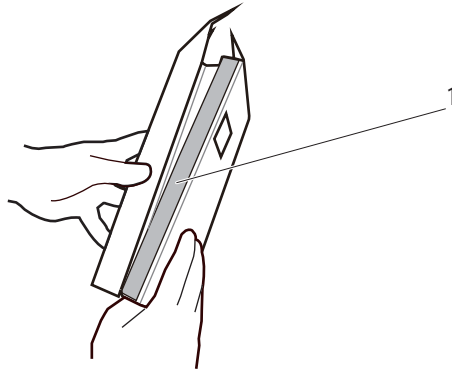

No.	Part Name
1	Double-sided tape

4. Fold in the upper side of the light-shielding case.

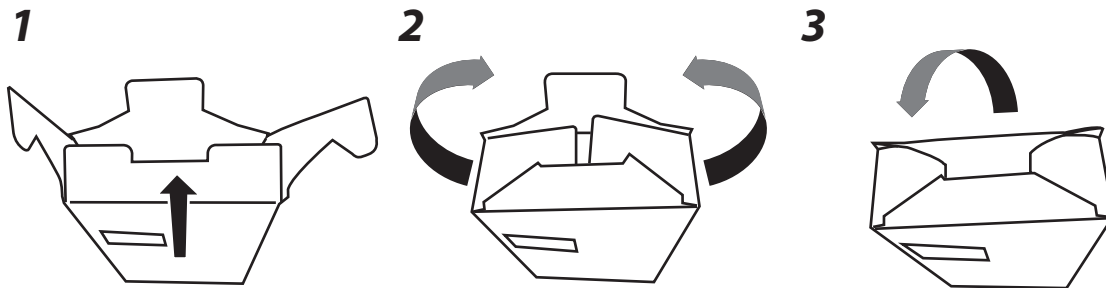

5. Assemble the rest of the light-shielding cases in the same way.

3 How to Use

This section describes how to use this product.

CAUTION

- **Be sure to read the “Handling UV Ink Jet Printers” sheet included with the printer before operating it.**

3.1 Installing Ink Packs

Follow the procedure below to install Ink packs.

1. Prepare High-capacity ink pack adapter.

NOTE

- When removing High-capacity ink pack adapter from the printer, refer to the Operation Manual of the printer.

2. Take out Ink pack and Smart chip card from the bag.
3. Install Smart chip card to High-capacity ink pack adapter as shown in the illustration.
 - Slide Smart chip card to install it on the tabs of High-capacity ink pack adapter.

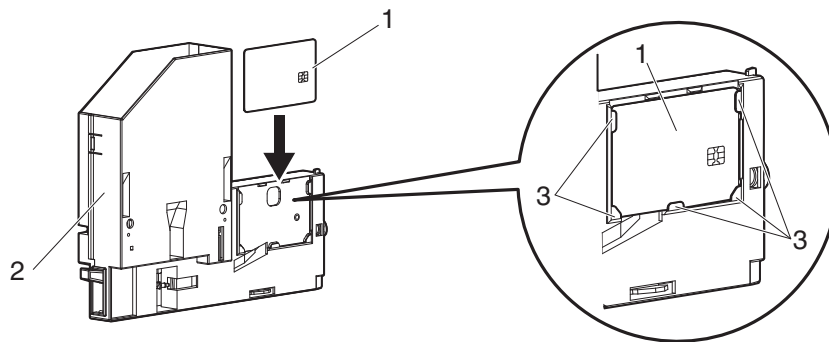

No.	Part Name
1	Smart chip card
2	High-capacity ink pack adapter
3	Tabs

4. Make sure that Smart chip card is inserted all the way in and that it is not installed over the top tabs.

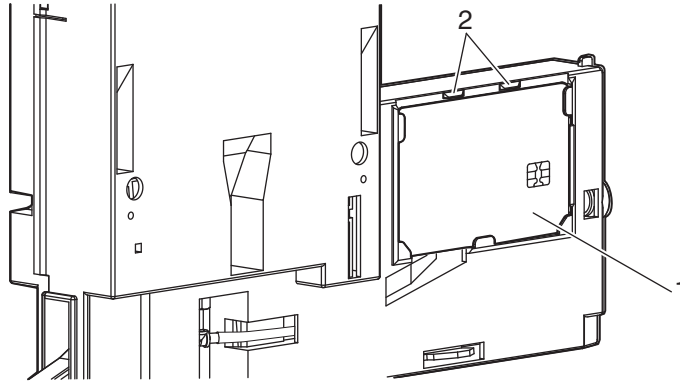

No.	Part Name
1	Smart chip card
2	Top tabs

5. Attach ink color labels to high-capacity ink pack adapter as shown in the illustration below.

- When there is no label of the color to use, write the color in the label for "Other" ink color label.

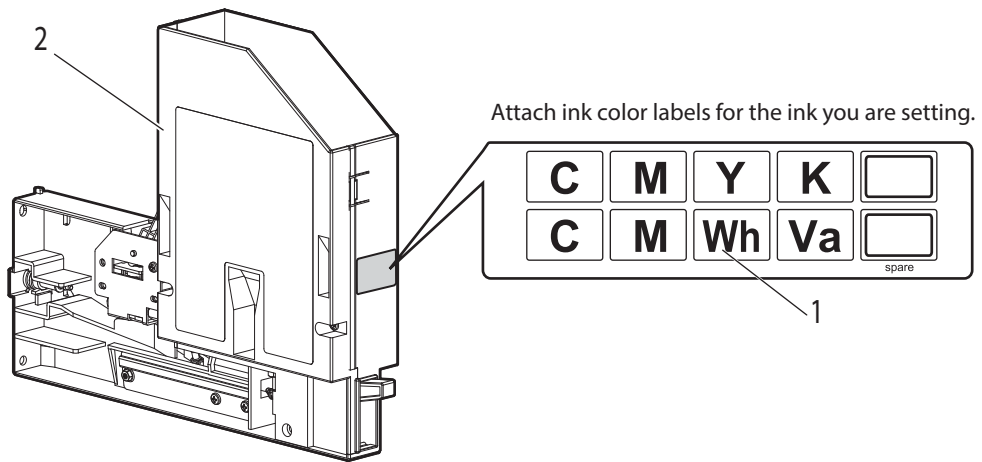

No.	Part Name
1	Ink color label
2	High-capacity ink pack adapter

6. While lowering Lock lever of High-capacity ink pack adapter, insert an Ink pack.
- a) Make sure to insert Ink packs all the way in High-capacity ink pack adapter.

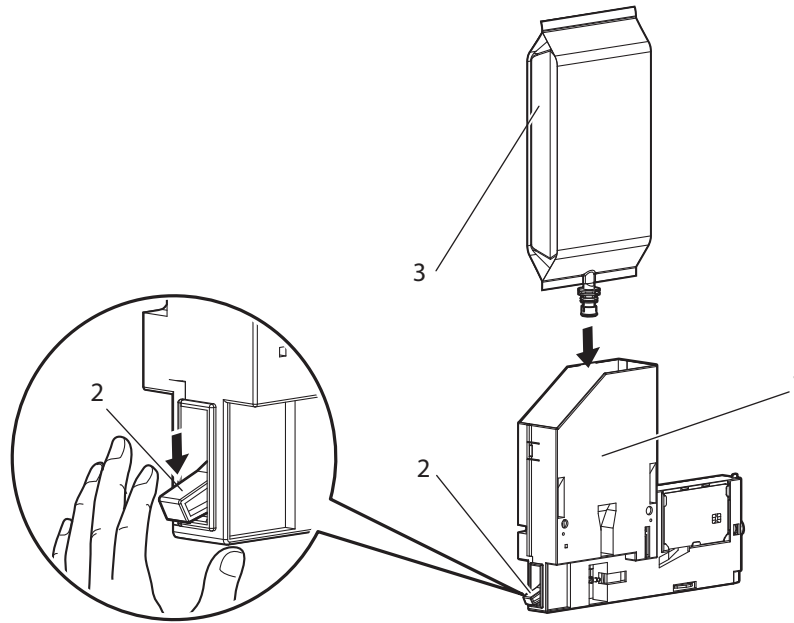

No.	Part Name
1	High-capacity ink pack adapter
2	Lock lever
3	Ink pack

- b) Confirm ink pack is fully seated by checking the lock mechanism is at the top of the ink delivery neck through the observation window, see proper placement in image below.

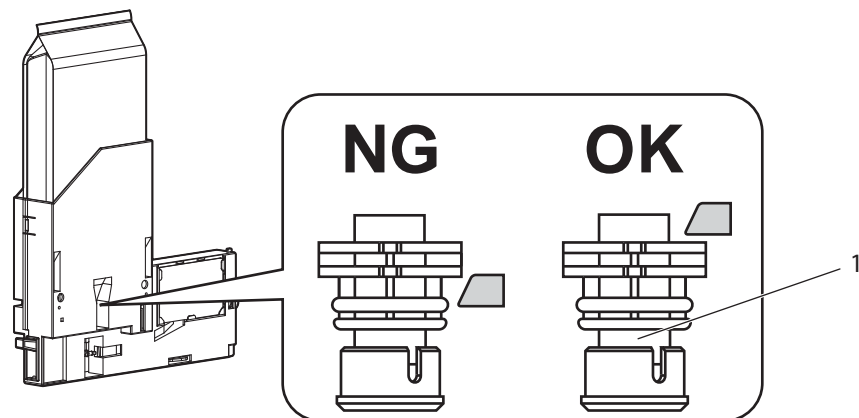

No.	Part Name
1	Ink pack

7. Make sure that Lock lever of High-capacity ink pack adapter is back to its original position.

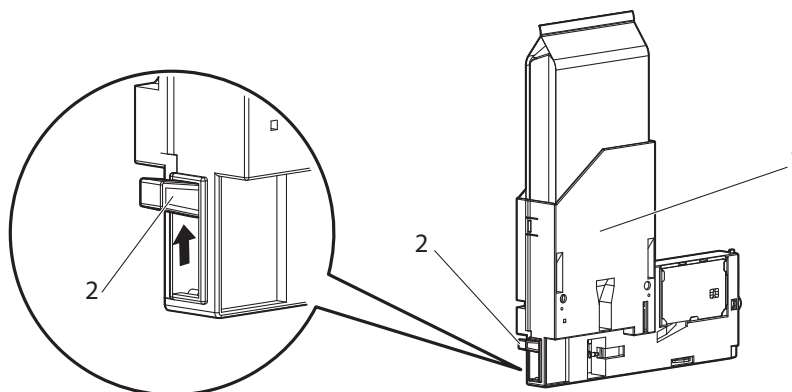

No.	Part Name
1	High-capacity ink pack adapter
2	Lock lever

NOTE

- After inserting an Ink pack to High-capacity ink pack adapter, if Lock lever does not return to its original position, push up the lever with your finger. If it still does not return, insert the Ink pack again.

CAUTION

- **If Lock lever does not return to its original position and is left that way, it may cause ink leakage.**

8. Place the light-shielding cover over the ink pack.
 - a) Set the light-shielding cover so that it fits into the high-capacity ink pack adapter.

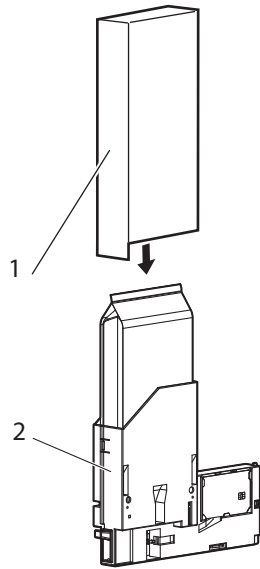

No.	Part Name
1	Light-shielding cover
2	High-capacity ink pack adapter

CAUTION

If the light-shielding cover is not set firmly inside the high-capacity ink pack adapter, the ink inside the pack may be transformed and the printer may be damaged.

- b) Check if the color name on the ink pack can be seen from the confirmation window in the light-shielding cover.
 - Also check that the ink color label you attached in Step 5 matches the ink pack's color name.

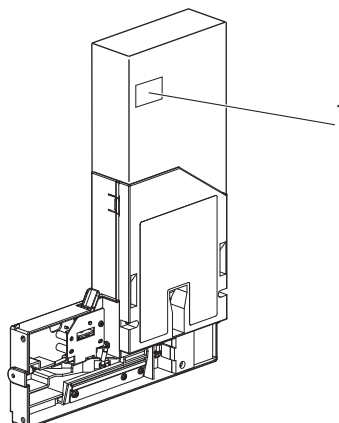

No.	Part Name
1	Confirmation window

9. In the same way, install Smart chip cards and Ink packs to other High-capacity ink pack adapters.

10. Install High-capacity ink pack adapter to the printer.

NOTE

- To install High-capacity ink pack adapter to the printer, refer to the Operation Manual of the printer.
-

3.2 When High-Capacity Ink Pack Adapter is removed from Printer

When the high-capacity ink pack adapter is removed from printer, follow the procedures below to wipe off the ink.

CAUTION

- **Make sure to wipe off the ink, when this product is removed from the printer.
If the ink is not wiped off, the ink may be attached to the printer.**

(1) Items to Prepare

- Rubber Gloves: Supplied with Printer (Commercially available solvent-resistant gloves can be used as an alternative.)
- Plastic Gloves: Supplied with Printer (Commercially available solvent-resistant gloves can be used as an alternative.)
- Goggles or Protective Glasses: Supplied with Printer (Commercially available goggles can be used as an alternative.)
- Protective Clothing (Commercially available)
- Paper Towel (Lint-free cloth): Supplied with Printer
(Commercially available lint-free cloth can be used as an alternative.)
- Cleaning Stick: Supplied with Printer
(Commercially available tissue can be used as an alternative.)

CAUTION

- **When performing work, be sure to wear the included gloves (or solvent-resistant gloves) and goggles, and be careful not to get ink on you.
If the UV curing ink or waste liquid gets on your skin or in your eyes, it may cause inflammation or an allergic reaction.**
- **Do not touch uncured ink with your bare hands.**
- **If ink gets on the gloves, replace them with new gloves.**
- **If ink gets on your clothes, promptly remove them and wash them if reusing them.**
- **If ink gets on your skin, immediately wash it for 15 minutes using soap and a profuse amount of water, and should any abnormality occur, seek medical attention/first aid.**
- **If ink enters your eye, wash it for 15 minutes using a profuse amount of water and promptly seek medical attention/first aid.**
- **If you swallow the ink, immediately rinse out your mouth, but do not force yourself to vomit. Seek medical attention/first aid.**

(2) Operation Procedures

1. Wear vinyl gloves.
 - ☞ (VJ-1626UH) Printer's Operation Manual "6.1 Wearing the gloves and goggles"
 - ☞ (VJ-426UF) Printer's Operation Manual "Wearing the gloves and goggles" P.71
2. Check if the printer is turned on.
3. Remove the high-capacity ink pack adapter from the printer.
4. Wipe off the ink attached around the inlet of high-capacity ink pack adapter using the paper towel supplied with the printer (or commercially available tissue).

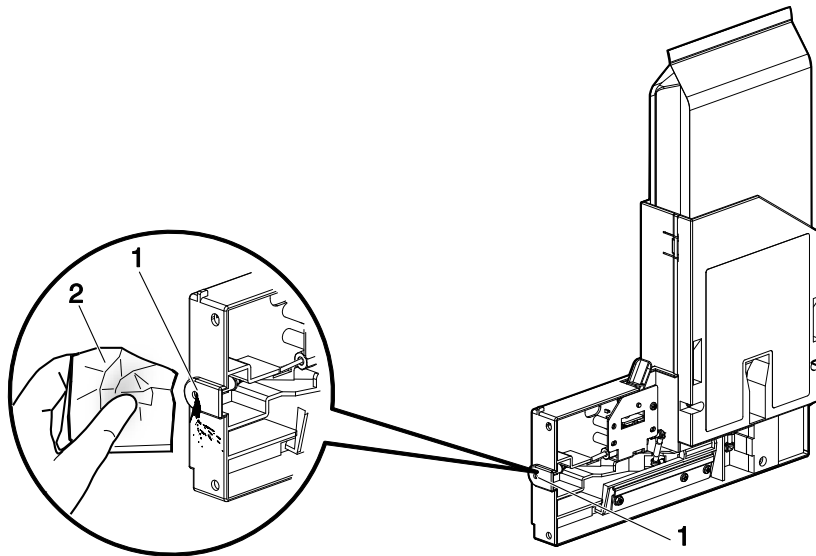

No.	Part Name
1	Inlet
2	Paper Towel

NOTE

- During work, be careful so that no dirt gets attached to the inlet of the high-capacity ink pack adapter.
 - If dirt gets attached, use the paper towel supplied with the printer to wipe it off.
-

5. Tilt the high-capacity ink bag adapter as shown in the figure below, remove the dropper ink using the cleaning stick supplied with the printer (or commercially available tissue with sharp-edged).
- Tilt the high-capacity ink bag adapter so that the inlet to be pointed downward a little.
 - Tilt the high-capacity ink bag adapter so that the caution label to be faced downward.
 - Remove the ink accumulated around the tube connector.

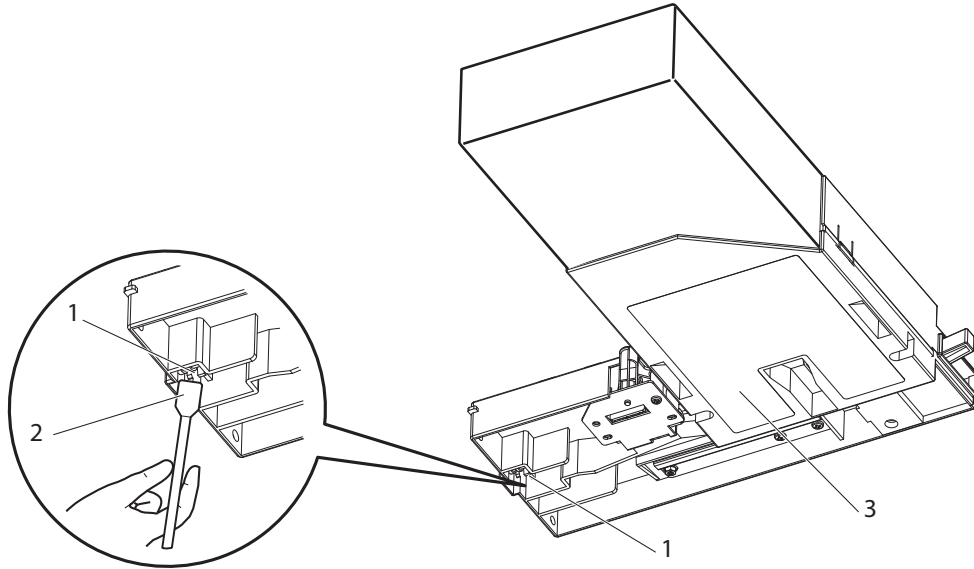

No.	Part Name
1	Tube Connector
2	Cleaning Stick
3	Caution Label

6. Attach the high-capacity ink pack adapter to the printer,

3.3 Replacing Connector Rubber

(1) When to replace

When “[*****] Change Plug” is displayed on the Operation panel;

- Connector rubber inside High-capacity ink pack adapter needs to be replaced.
- Warning buzzer keeps going off.
To stop the buzzer, press the [Enter] key on the Operation panel.
- Replace with a new Connector rubber.

NOTE

- [*****] of the display at the time of replacing Connector rubber indicates the ink color of the cartridge whose Connector rubber is to be replaced.
 - The display differs depending on the printer model. For details, refer to the Operation Manual of the printer.
- Insert/remove High-capacity ink pack adapter at the time of replacement only.
Inserting or removing High-capacity ink pack adapter mixes air into the ink tube, and failures such as missing nozzles may occur.
- If you do not have an extra Connector rubber, keep High-capacity ink pack adapter inserted in the printer.
Leaving the printer without High-capacity ink pack adapter can clog the Head.



CAUTION

- **Using the printer without replacing Connector rubber can cause ink leakage.**

(2) What to prepare

- Rubber Gloves: Supplied with Printer (Commercially available solvent-resistant gloves can be used as an alternative.)
- Plastic Gloves: Supplied with Printer (Commercially available solvent-resistant gloves can be used as an alternative.)
- Goggles or Protective Glasses: Supplied with Printer (Commercially available goggles can be used as an alternative.)
- Protective Clothing (Commercially available)
- Fine-tipped tool (such as precision screwdrivers): Commercially Available
- Connector rubber: Included with the printer
- Paper Towel (Lint-free cloth): Supplied with Printer
(Commercially available lint-free cloth can be used as an alternative to paper towel.)
- Cleaning Stick: Supplied with Printer
(Commercially available tissue can be used as an alternative to paper towel.)

NOTE

- When the included Connector rubbers have run out, contact your local MUTOH dealer.



CAUTION

- **When performing work, be sure to wear the included gloves (or solvent-resistant gloves) and goggles, and be careful not to get ink on you.**
If the UV curing ink or waste liquid gets on your skin or in your eyes, it may cause inflammation or an allergic reaction.
- **Do not touch uncured ink with your bare hands.**
- **If ink gets on the gloves, replace them with new gloves.**
- **If ink gets on your clothes, promptly remove them and wash them if reusing them.**
- **If ink gets on your skin, immediately wash it for 15 minutes using soap and a profuse amount of water, and should any abnormality occur, seek medical attention/first aid.**
- **If ink enters your eye, wash it for 15 minutes using a profuse amount of water and promptly seek medical attention/first aid.**
- **If you swallow the ink, immediately rinse out your mouth, but do not force yourself to vomit. Seek medical attention/first aid.**

(3) How to replace

CAUTION

- Do not replace the Connector rubber in a place with direct sunlight or strong light.

Follow the procedure below to replace Connector rubber.

1. Wear vinyl gloves.
 - ☞ (VJ-1626UH) Printer's Operation Manual "6.1 Wearing the gloves and goggles"
 - ☞ (VJ-426UF) Printer's Operation Manual "Wearing the gloves and goggles" P.71
2. Make sure that the printer is turned ON.
3. Remove High-capacity ink pack adapter to be replaced from the printer.
4. Wipe off excess ink on the high-capacity ink pack adapter.
 - ☞ 3.2 Refer to "Removing High-Capacity Ink Pack Adapter from Printer."

NOTE

- During work, be careful so that no dirt gets attached to the inlet of the high-capacity ink pack adapter.
- If dirt gets attached, use the paper towel supplied with the printer to wipe it off.

5. Use a fine-tipped tool to push out Tube connector from the left gap of High-capacity ink pack adapter.

NOTE

- When pushing Tube connector, be careful not to damage it with the tool.

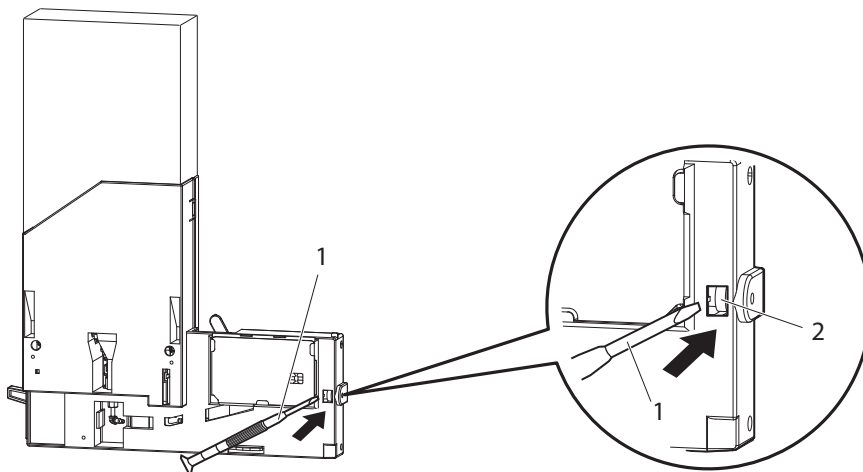

No.	Part Name
1	Fine-tipped tool
2	Tube connector

6. Lay the high-capacity ink pack adapter sideways gently so that the caution label to be faced upward.

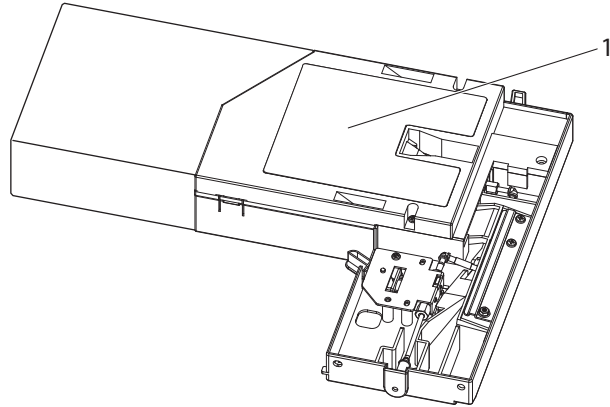

No.	Part Name
1	Caution Label

7. Use a fine-tipped tool to remove Connector rubber from Tube connector.

NOTE

- Please bend the tube connected to tube connector as little as possible. The tube may be broken.
- When removing Connector rubber, do not face the opening of Tube connector downward. The remaining ink in the tube may leak.

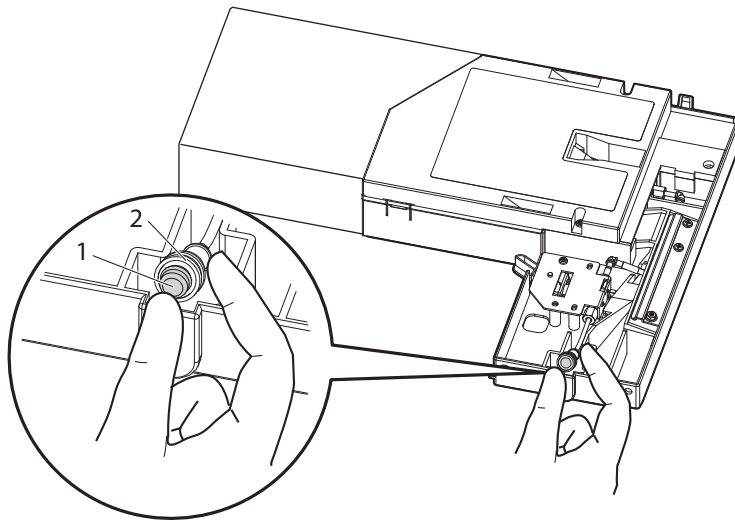

No.	Part Name
1	Fine-tipped tool
2	Tube connector
3	Connector rubber

8. Push a new connector rubber into the tube connector about a half way.

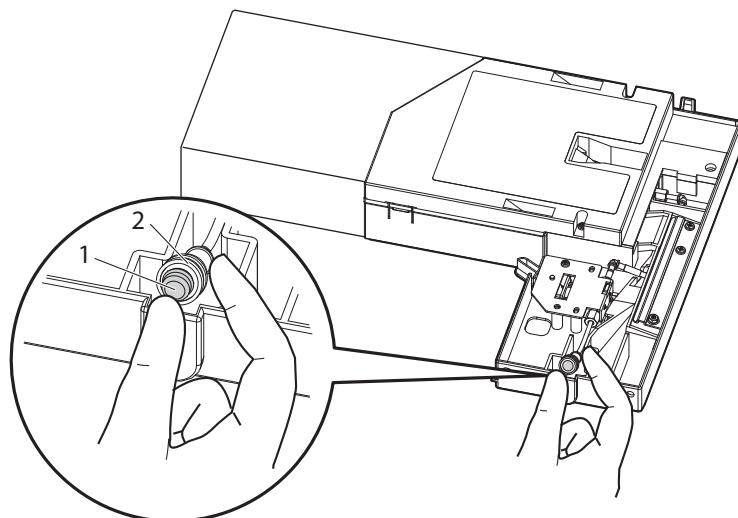

No.	Part Name
1	Connector Rubber
2	Tube Connector

9. Push the connector rubber into the tube connector completely with pressing the choke valve lever.

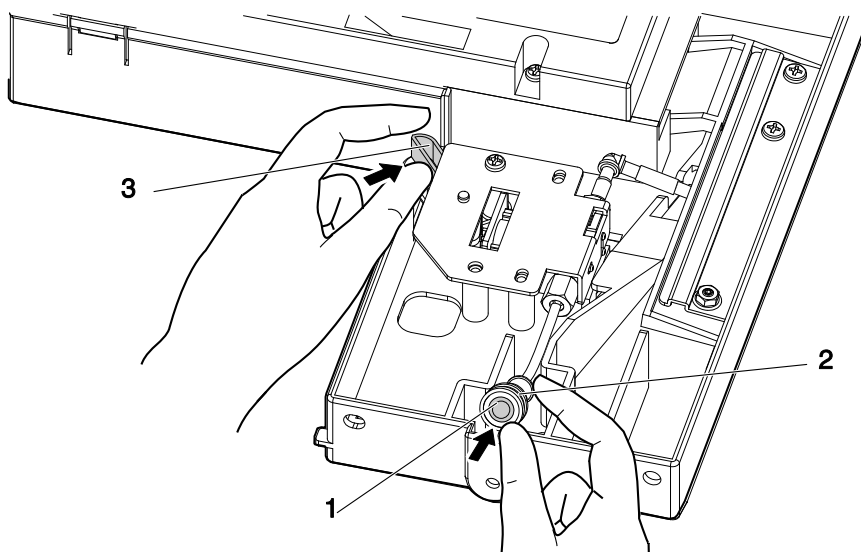

No.	Part Name
1	Connector Rubber
2	Tube Connector
3	Choke Valve Lever

10. Install Tube connector back to the tabs of High-capacity ink pack adapter securely.

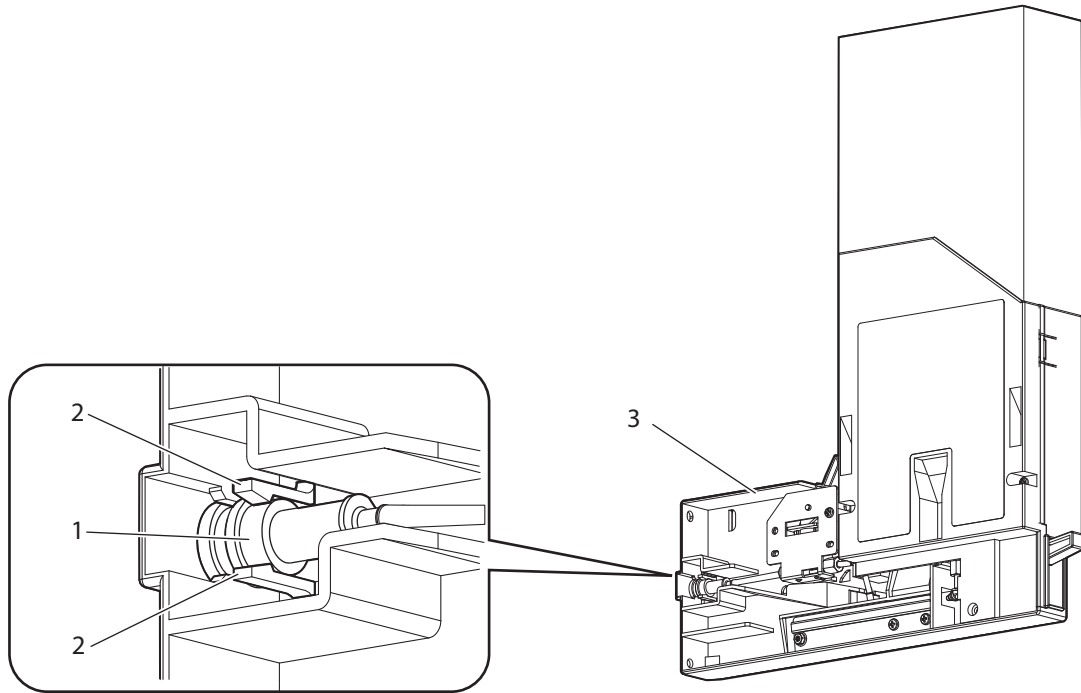

No.	Part Name
1	Tube connector
2	Tabs
3	High-capacity ink pack adapter

NOTE

- If Tube connector is not securely installed to the tabs, High-capacity ink pack adapter may not be installed to the printer correctly.

11. Install High-capacity ink pack adapter to the printer.

- Replacing Connector rubber is complete.

<MEMO>

MUTOH

MUTOH INDUSTRIES LTD.
Tel.:81-(0)3-6758-7020
Fax:81-(0)3-6758-7025
E-mail:ibd@mutoh.co.jp
<http://www.mutoh.co.jp/en/index.html>

MUTOH AMERICA INC.
Tel.:1-480-968-7772
Fax:1-480-968-7990
E-mail:sales@mutoh.com
<http://www.mutoh.com>

MUTOH BELGIUM nv
Tel.:32-(0)59-561400
Fax:32-(0)59-807117
E-mail:mutoh@mutoh.be
<http://www.mutoh.be>

MUTOH DEUTSCHLAND GmbH
Tel.:49-(0)211-385474-0
Fax:49-(0)211-385474-74
E-mail:vertrieb@mutoh-gmbh.de
<http://www.mutoh.de>

MUTOH North Europe S.A.
Tel.:352-445-906
Fax:352-447-093
E-mail:info@segroup.lu
<http://www.segroup.lu/>

MUTOH HONGKONG LTD.
Tel.:852-2377-3411
Fax:852-2377-3422
<http://www.mutoh.co.jp/en/index.html>

MUTOH SINGAPORE PTE.LTD.
Tel.:65-6325-3150
Fax:65-6220-4342
E-mail:sales_inq@mutoh-sg.com
<http://www.mutoh.co.jp/en/index.html>

MUTOH AUSTRALIA PTY. LTD.
Tel.:61-2-9437-1366
Fax:61-2-9436-2871
E-mail:sales@mutoh-au.com
<http://mutoh-au.com/>